



447 College Drive • Sylva, North Carolina 28779

*Serving Jackson, Macon, Swain Counties and the Qualla Boundary*



**HEALTH SCIENCES BUILDING**



# Message from SCC's President

Nearly 55 years ago, our college's founding fathers constructed the first building on what would become the Jackson Campus. We will soon break ground on our 10th building, a state-of-the-art health sciences facility. Our goal is to equip this new facility with the latest medical equipment and technology to provide our students hands-on skills using exactly the same machines and devices they'll encounter their first day on the job. We also want to make sure every deserving student has the means to pursue a degree through our nationally acclaimed health sciences programs to address the critical shortage and acute demand for healthcare professionals.

In the first year following completion, the new health sciences facility will give 144 additional students the opportunity to enroll in one of our 14 healthcare programs. This new facility will also enable the addition of three new health science programs, potentially increasing health sciences enrollment to 288 in the third year.

It's important to note that the graduates of these programs can expect starting salaries significantly higher than the median poverty wage for both 2 and 4 person families. Nearly 90% of our graduates remain in western North Carolina, providing the region with well-trained healthcare professionals while stimulating the local economy through higher salaries.

That's where you come in. We hope you will consider investing in our region's future through the philanthropic prospects represented by our new facility.



  
Dr. Don Tomas  
SCC President

*Thank you for your interest in SCC, and I look forward to meeting with you to discuss this exciting project and the opportunities it represents for you, our students and our communities.*

## Contact Information



**Dr. Don Tomas**  
*SCC President*  
828.339.4239  
d\_tomas@southwesterncc.edu  
Burrell Building, Room 103



**Brett Woods, CFRE**  
*Director of SCC Foundation*  
828.339.4241  
b\_woods@southwesterncc.edu  
Burrell Building, Room 102

### Follow our construction progress on Social Media!



[www.facebook.com/sccnc1/](https://www.facebook.com/sccnc1/)



[@southwesterncc](https://www.instagram.com/southwesterncc)



[@SouthwesternCC](https://twitter.com/SouthwesternCC)



Discover the far-reaching impact of community colleges on today's economy: [youtu.be/zs6nQpVI164](https://youtu.be/zs6nQpVI164)

## Health Sciences Programs

- Emergency Medical Science
- Health Information Technology
- Human Services Technology
- Medical Assisting
- Medical Laboratory Technology
- Medical Sonography
- Nursing
- Nurse Aide
- Occupational Therapy Assistant
- Outdoor Leadership
  - Wilderness Emergency Medicine
  - Wilderness Therapy
- Phlebotomy Certificate
- Physical Therapist Assistant
- Radiography
- Respiratory Therapy
- Therapeutic Massage

### NEW Programs! (following construction)

- Surgical Technology
- Opticianry
- Speech Language Pathology Assistant

# Floor Plan - Details (Naming Opportunities)

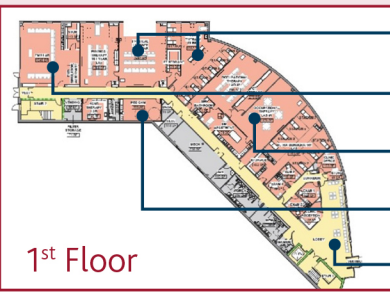

- Physical Therapy Classrooms/Lab
- Emergency Medical Science Lab
- Occupational Therapy Classrooms/Lab
- Pediatric Gym
- Clinic Reception

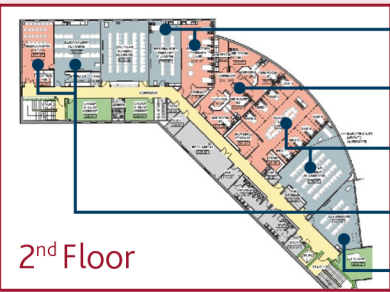

- Respiratory Therapy Classrooms/Lab
- Simulation Lab
- Nursing Classroom/Lab
- Radiography Classrooms/Lab
- Sonography Classroom

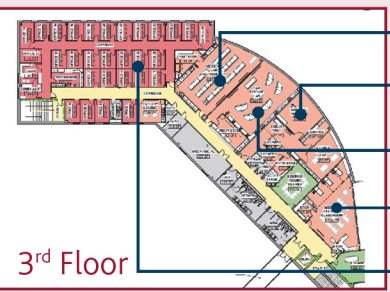

- Medical Lab Technology Classroom
- Surgical Technology Lab
- Anatomy & Physiology Lab
- Medical Assisting Classroom
- Faculty/Staff Offices

## Building Details

(Data is projected & subject to change)

### Budget

\$20 million

### Square Footage

55,411

### Classrooms/Labs

23

### Programs in Building

10

### Additional Students Served

288 (144 each of first two years)

### Projected Completion Date

Fall 2020/Spring 2021

# Make a Difference!

→ **Naming Opportunities** - By naming a space in our new health sciences facility, you partner with us in providing the solution to our region's health care professional shortage. Your gift will help thousands of students and create a legacy that will last for generations. Naming opportunities are available on all floors (see Floor Plan).

→ **Endowed Scholarship** - Honor a family member, loved one or perhaps a revered healthcare professional in perpetuity by establishing a fund that will help future healthcare professionals earn their degrees.

→ **Legacy Gifts** - Solidify your legacy by remembering SCC's Health Sciences in your estate plan. You may also create an endowed scholarship via your estate plan.





# SCC Health Sciences Alumni

Training Healthcare professionals throughout Jackson, Macon, Swain Counties and the Qualla Boundary



**Stephanie Crawford,**  
*2012 Graduate  
Nursing*  
Highlands-Cashiers  
Hospital

**SCC Graduates,**  
Mission Community  
Primary Care of  
Cashiers



**Danae Woodard,**  
*2018 Graduate  
Radiography*  
Angel Medical Center

**Hannah Caplinger,**  
*2014 Graduate  
Nursing*  
Harris Regional  
Hospital



**Adam Barker,**  
*2018 Graduate  
Nursing*  
Swain Community  
Hospital

**Daniel Trantham,**  
*2018 Graduate  
Radiography*  
Cherokee Indian  
Hospital



# Economic Impact

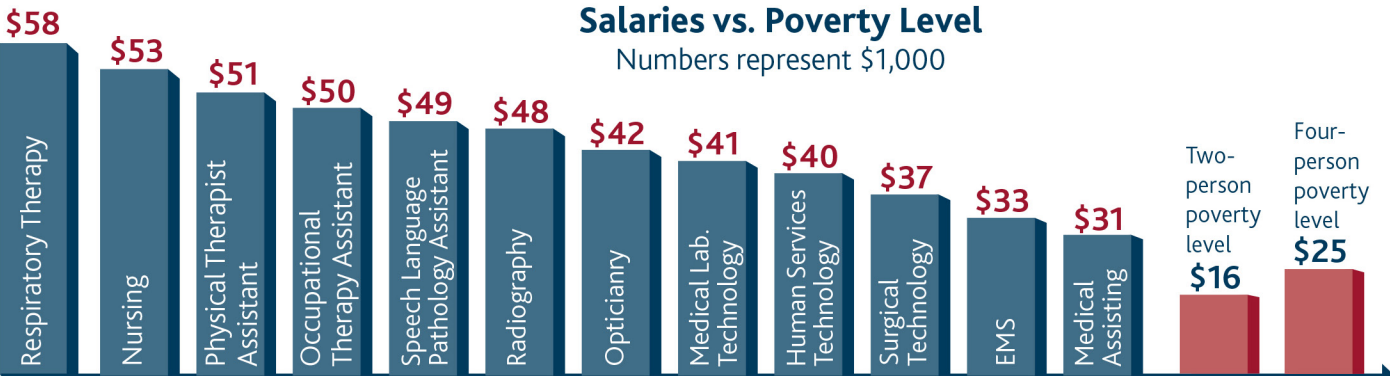

Salaries reflect entry-level earnings for recent graduates. Poverty level income is based on the N.C. standard for a family of two as of July, 2018

